

# Loop – Available Locum/Bank Duties

1

Select **Available Bank Duties** or **Available Locum Duties** from the Loop main screen

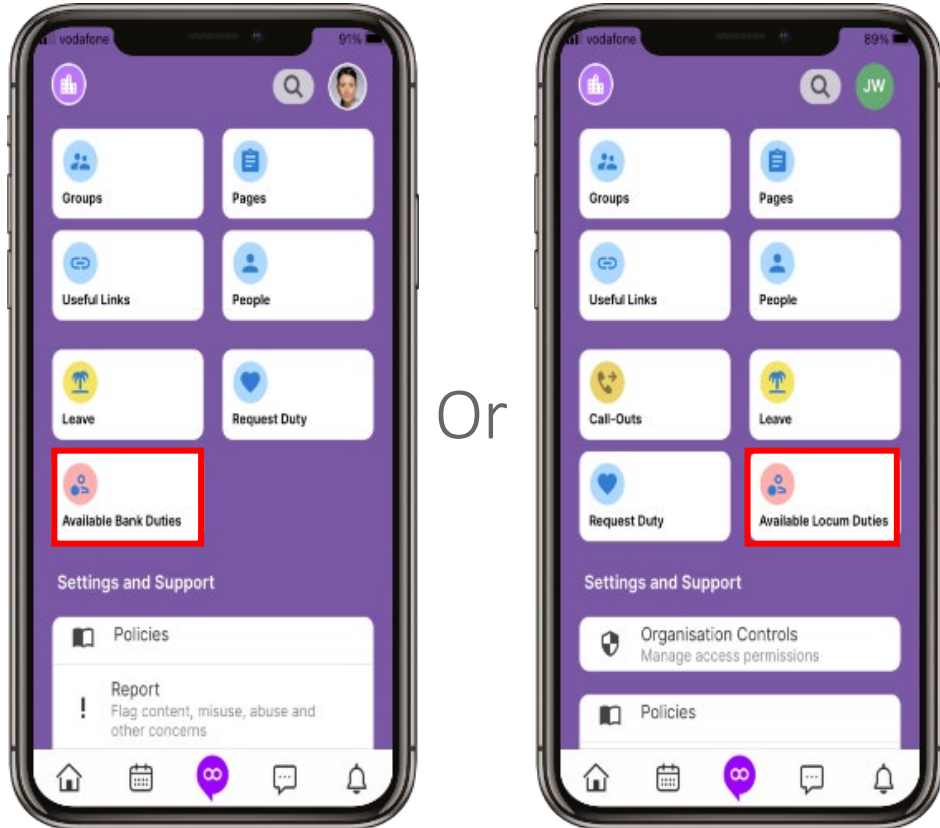

2

Select an **Available Duty** from the list



3

Select the green **Express Interest** button

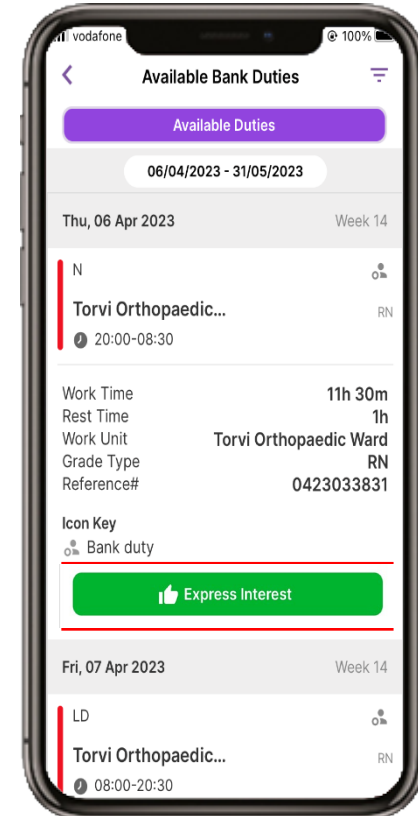

# Loop – Available Locum/Bank Duties

4

You can filter available shifts by clicking the icon in the top right hand corner and scrolling through the options as needed

